

MANOR

RIVERSIDE

RIVERFRONT CHARM MEETS LUXURY LIVING

Welcome to Manor Riverside, a luxury apartment community designed to be part of the new, rapidly growing West River neighborhood. Surrounded by soaring, majestic oak trees, with spectacular views of Hillsborough River and the downtown skyline, Manor Riverside is a unique urban retreat with an extensive suite of indoor and outdoor amenities—close to the best of Tampa, surrounded by a welcoming, close-knit community in a naturally beautiful setting. Discover an incomparable blend of lifestyle and location, in a welcoming and outdoor-loving community.



Artist's Conceptual Rendering - Entrance



Artist's Conceptual Rendering - Clubroom

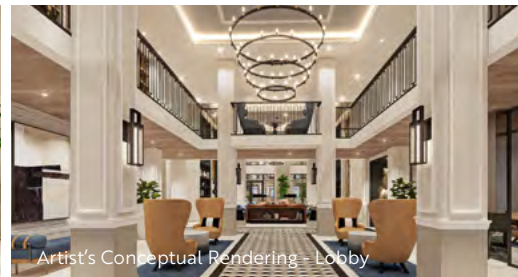

Artist's Conceptual Rendering - Lobby

THE BEST OF MANOR WEST RIVER AT A GLANCE

Come home to breathtaking river and downtown skyline views, all within walking distance of spacious parks, Tampa Riverwalk, Armature Works, pickleball courts, shopping, restaurants, and more.

ONE-OF-A-KIND LOCATION

- Located directly between The Heights and North Hyde Park Village, Manor Riverside is minutes from a world of outdoor activities, including Julian B. Lane Park, beautiful beaches, waterfront restaurants, marinas and more.
- Just a 10-minute drive to downtown Tampa, Hyde Park, and Tampa International Airport
- Steps from a brand-new Publix market, opening soon
- Pristine dog-friendly park within walking distance

INSPIRING INTERIORS

- Thoughtfully designed studio- to three-bedroom residences
- Spacious standard and wraparound* balconies with unobstructed river and downtown skyline views
- Generous walk-in closets
- Designer kitchens appointed with under-cabinet ambient lighting and top-tier Samsung appliance package
- Wood plank flooring throughout residences, all carpet-free
- Sleek designer baths with serene lighting, double vanities*, glass shower enclosures and premium fixtures including TOTO toilets
- In-residence full-size Samsung washer & dryer
- Versatile open floor plans, filled with natural light, created with style, function, and comfort in mind
- Custom built-in desks, designed for use as remote workstations, dressing tables, and more

*Select residences

ABUNDANT OUTDOOR ACTIVITIES

- Expansive 4,500 square-foot rooftop terrace overlooking the riverfront, with fire pits, grilling stations, TVs, and plenty of gathering room
- Glittering 6,000 square-foot pool deck with resort-style pool, hot tub, fire pit, grilling station, cabanas, and more—all designed for connecting, relaxing, and recharging
- Impeccably landscaped, 2,250 square-foot social courtyard with oversized TVs, lounge seating, ping pong, billiards, grilling stations, and dining tables

16,000 SQUARE FEET OF INDOOR AMENITIES

- 2,100+ square-foot fitness center equipped with treadmills, ellipticals, Stairmasters, bikes, state-of-the-art CLMBR, rowing machine, and TRX weight training
- Dedicated yoga and spin studio with Echelon Mirrors and Bikes
- Expansive spa with beauty bar, massage room, manicure/pedicure station, cold plunge, and sauna overlooking the pool deck
- For hosting and toasting: two residents' cocktail bars, two catering kitchens, fully appointed third game room, and cutting-edge media studio with theater screen.
- Convenient, flexible coworking spaces
- High-speed fiber optic WiFi.
- Amazon package room.